

FORMER BIG CHILL BAR | EVENTS SPACE

FORMER BIG CHILL BAR

THE
T B R E W E R Y
M A N Y

FORMER BIG CHILL BAR | EVENTS SPACE



EVENTS



FASHION
SHOWS



MUSIC



PARTIES



FOOD & DRINK



FILM &
PHOTOGRAPHY



LICENSED

ABOUT

Transform our industrial blank canvas bar into your brand's urban playground. Located on Dray Walk, just off London's iconic Brick Lane, this versatile 300-capacity space is primed for unforgettable events. Embrace the raw, industrial charm and make your mark in the heart of East London's trendiest district. Our prime location ensures your activation benefits from the vibrant energy and foot traffic of Brick Lane, while Dray Walk provides an exclusive setting for your branded experience. With ample room for creativity, our space offers the perfect backdrop for: Product launches that captivate, Immersive brand experiences, Pop-up events that stand out, Creative workshops and showcases. Turn our blank canvas into your masterpiece.

ADDRESS

Dray Walk, London, E1 6QL

CAPACITY

Event specific

SIZE

3,000 sqft

LEVEL

Ground floor

LOCATION

Situated on Dray Walk.

ACCESS

Access and loading is via Ely's Yard / Hanbury Street to Dray Walk.

POWER

13 amp sockets

COMMS

The Truman Brewery's dedicated on-site service provider, TruTec Services, can easily provide support, networking, telephony and internet connectivity to this location.

LIGHTING

House Lights

SERVICES

Kitchenette, Bar and toilets.

SUPPLIERS

We recommend the use of the following teams:

EVENT PRODUCTION:

E1 PRODUCTIONS

INTERNET CONNECTIVITY:

TRUTEC SERVICES

SECURITY:

Trusec Security Ltd.
Event Security Services

EVENT CLEANING SERVICES:

The Truman Brewery
Event Cleaning Services



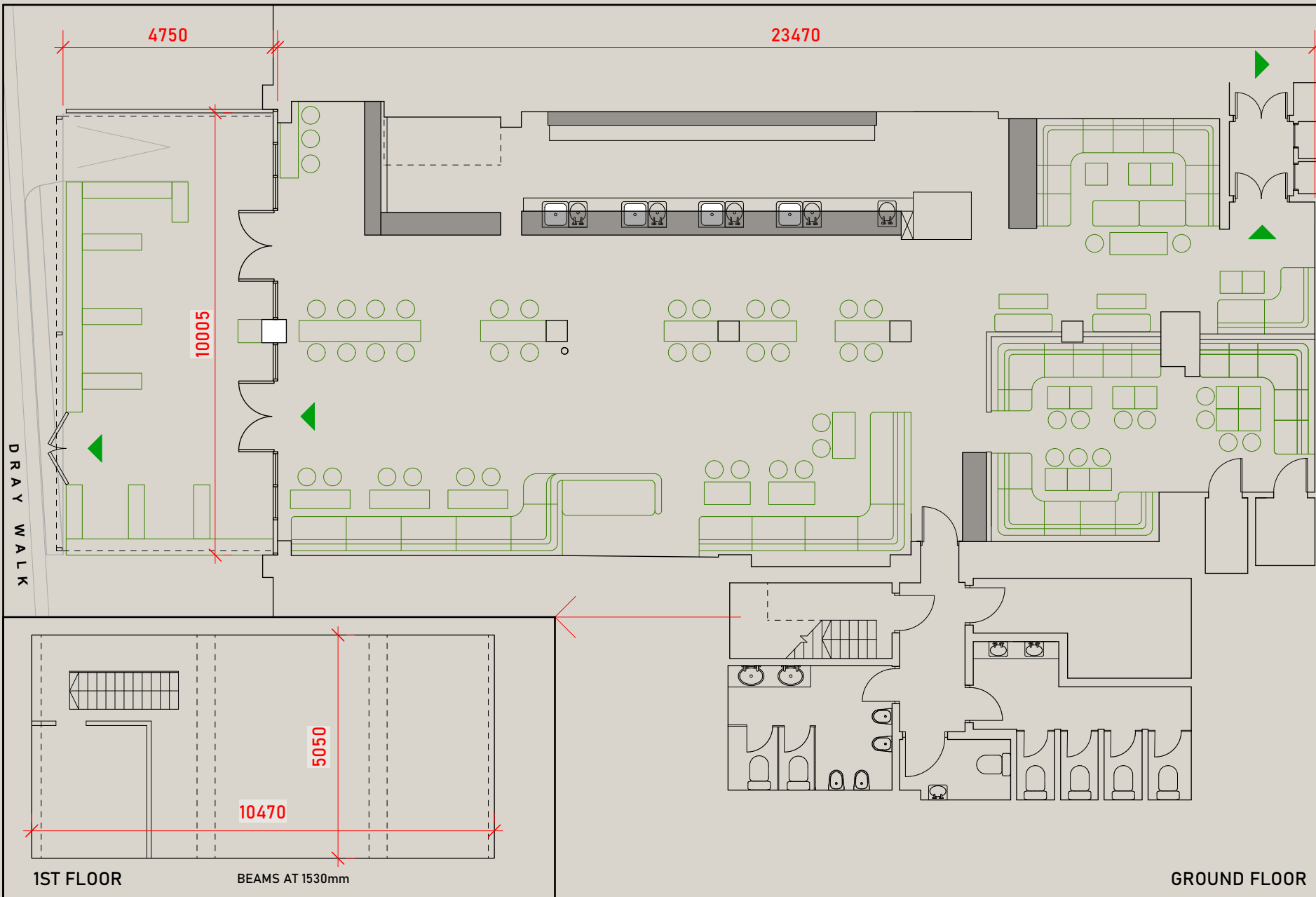

THE TRUMAN BREWERY

A: 91 Brick Lane, London E1 6QL
T: 0207 770 6011
E: monika@trumanbrewery.com

DRAWING NAME

CG-002

SPACE DETAILS

C BLOCK
GROUND FLOOR
AND FIRST FLOOR
BASIC PLAN

VENUE LOCATION

C Block
Dray Walk
London E1

LEASE AREA

Ground external - 503 sqft

Ground internal - 3064 sqft

First internal - 546 sqft

SCALE

1:120 @ A4

NOTES

▼ FIRE EXIT

All measurements are approximate.
Measurements in millimetres.

DO NOT SCALE .
IF IN DOUBT ASK.

TRANSPORT

Dray Walk and The Truman Brewery have probably the most central Shoreditch location, and are easily reached by bus, rail, tube or on foot.

The venue benefits from close access to all forms of public transport. Liverpool Street and Shoreditch High Street stations are a short distance away, with Aldgate East within easy reach, offering fast connections across London and beyond.

Liverpool Street Station
Walking distance: 10 min

CENTRAL

CIRCLE

H&C

METROPOLITAN

NATIONAL RAIL

OVERGROUND

Shoreditch High Street Station
Walking distance: 5 min

OVERGROUND

Aldgate East Station
Walking distance: 10 min

DISTRICT

H&C

Whitechapel Station
Walking distance: 15 min

DISTRICT

H&C

OVERGROUND

Contact us to arrange a viewing:

Phone

+44(0)20 7770 6001

Email

events@trumanbrewery.com

Drop in

The Truman Brewery Events Department,
E y's Yard,
15 Hanbury Street,
London E1 6QR