

F BLOCK G1 | EVENTS SPACE

F BLOCK G1

THE
T R U M A N
B R E W E R Y



F BLOCK G1 | EVENTS SPACE



EVENTS



MARKETS



RETAIL



FOOD & DRINK



LICENSED

ABOUT

G1 is a substantial former ground floor warehouse. The space features dual aspect glass frontage that opens onto Brick Lane and Hanbury Street, providing high visibility and multiple entrances. The location is perfectly suitable for landmark exhibitions, shopping events, consumer and trade shows, fashion shows, conferences and space for filming support.

LOCATION

G1 is located on the west side of the Truman Brewery Estate, on the ground floor of F Block Events Building, bounded by Brick Lane, Hanbury Street and Ely's Yard. The area attracts many thousands of visitors to the bustling work spaces, themed events, weekend markets, eye-popping street art, boutiques, cafes and rich diversity of restaurants.

ADDRESS

Deliveries: 15 Hanbury Street, E1
Brick Lane Guests: 81 Brick Lane, E1

CAPACITY

Event Specific

SIZE

5,300 sqft

LEVEL

Street Level / Ground floor

CEILING HEIGHT

2.8m

F BLOCK G1 | EVENTS SPACE



ACCESS

Guest access is via Brick Lane, Hanbury Street or Ely's Yard. Loading access is Ely's Yard.

SERVICES

Water supply is available, subject to prior consent.

GI is serviced by a glass front that opens wide to accommodate some vehicular access.

COMMS

The Truman Brewery's dedicated on-site service provider, TruTec Services, can easily provide support, networking, telephony and internet connectivity to this location.

POWER

Twin 13A Sockets throughout.
4 x 63A 3 Phase C Form Socket.

LIGHTING

Strip Lights.

SUPPLIERS

We recommend the use of the following teams:

EVENT PRODUCTION:

E1 PRODUCTIONS

INTERNET CONNECTIVITY:

TRUTEC SERVICES

SECURITY:

Trusec Security Ltd.
Event Security Services

EVENT CLEANING SERVICES:

The Truman Brewery
Event Cleaning Services





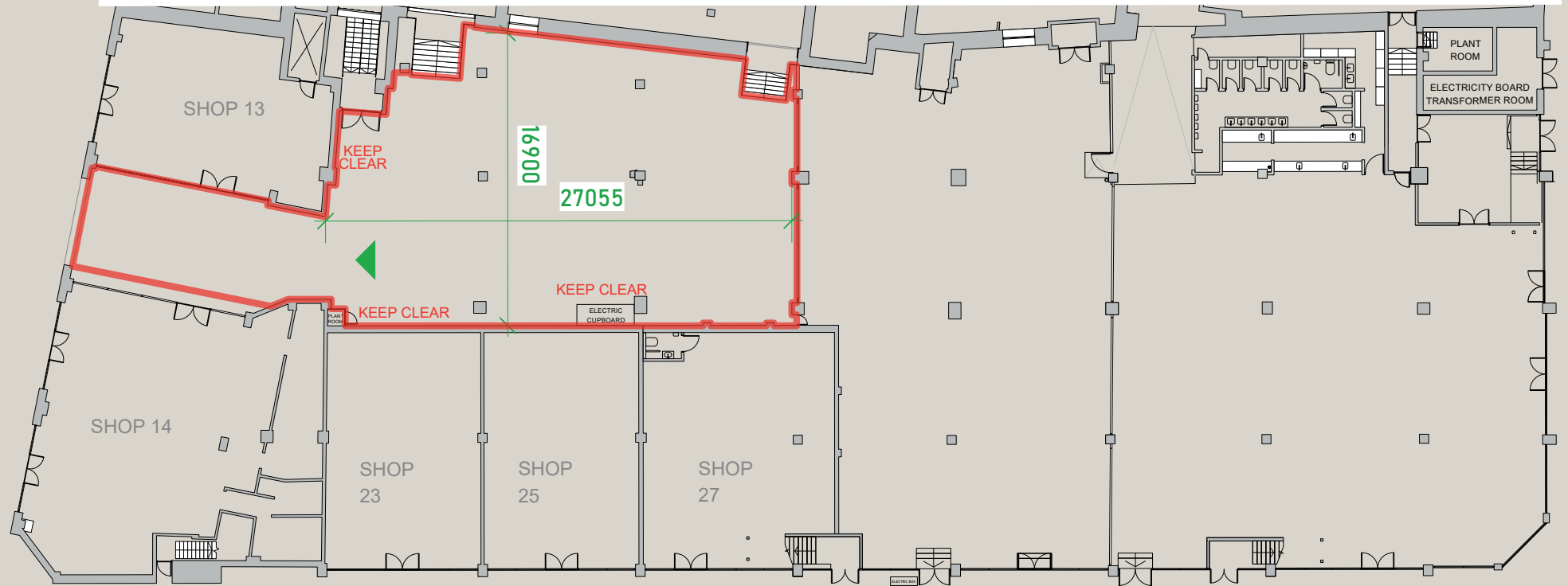

FLOOR PLAN - F BLOCK G1



nola

SWEDISH
NINJA

Exit →

TRANSPORT

F Block and The Truman Brewery have probably the most central Shoreditch location, and are easily reached by bus, rail, tube or on foot.

The venue benefits from close access to all forms of public transport. Liverpool Street and Shoreditch High Street stations are a short distance away, with Aldgate East within easy reach, offering fast connections across London and beyond.

Liverpool Street Station
Walking distance: 10 min

CENTRAL

CIRCLE

H&C

METROPOLITAN

NATIONAL RAIL

OVERGROUND

Shoreditch High Street Station
Walking distance: 5 min

OVERGROUND

Aldgate East Station
Walking distance: 10 min

DISTRICT

H&C

Whitechapel Station
Walking distance: 15 min

DISTRICT

H&C

OVERGROUND

Contact us to arrange a viewing:

Phone

+44(0)20 7770 6001

Email

events@trumanbrewery.com

Drop in

The Truman Brewery Events Department,
E y's Yard,
15 Hanbury Street,
London E1 6QR