

U BLOCK

Situated on the east side of The Old Truman Brewery Estate and with an entrance directly on Brick Lane, this warehouse style ground floor unit benefits from high ceilings, white walls and concrete flooring. It is the ideal unit base for filming locations in or around Central London, and has been host to many special events including fashion shows and film screenings.



The Old Truman Brewery is an historic 11 acre site on Brick Lane, London E1, housing a variety of unique dry hire, blank canvas-style spaces for rental / leasehold, ranging from 2,000 sqft to 100,000 sqft.

The site has grown to become 'The dynamic centre' for the new wave of young creative business entrepreneurs in London. It spans both sides of Brick Lane just to the east of The City. The 19 buildings that encompass the site range in architectural style and size, with courtyards and alleyways steeped in history and fable running between them, maintaining the ambience of this seventeenth century treasure chest. The Brewery combines both office and event spaces and is now the home to some of the most exciting, creative businesses and retail outlets in London. Cafes sit alongside hairdressers, clothing and furniture shops and at night Londoners descend upon The Brewery's own Vibe Bar, The Big Chill Bar and 93 Feet East live music venue for some of the coolest nights out in London.

Labelled "... the eye of the creative storm in London's East End" by The Independent, it is at the heart of one of London's most exciting areas.

The Old Truman Brewery continues to grow, remaining as pragmatic as ever and constantly adapting to the demands of the eclectic marketplace that it created.

CONTACT
020 7770 6100
events@trumanbrewery.com
www.trumanbrewery.com
The Old Truman Brewery
91 Brick Lane London E1 6QL

THE
OLD TRUMAN
BREWERY

TRUMAN

U BLOCK

Specifications

size (approx)
7,800 sqft

capacity
300 dependant on use of premises

floor
ground

production rooms
one

toilets
one (in production office)

access
power run roller shutter at front of venue
rear access via Brick Lane car park

lights
strip lighting throughout

power
13amp sockets

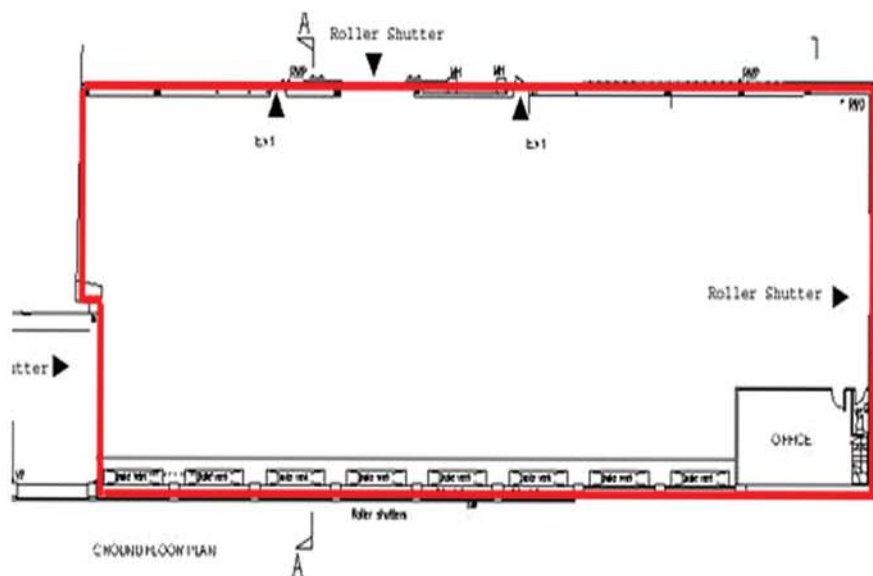

Price List

weekday prices only

weekend price is subject to additional rates
(excluding VAT, electrics & damage deposit)

day	hire fee
1	£2,000
2	£2,900
3	£3,800
4	£4,500
5	£5,000

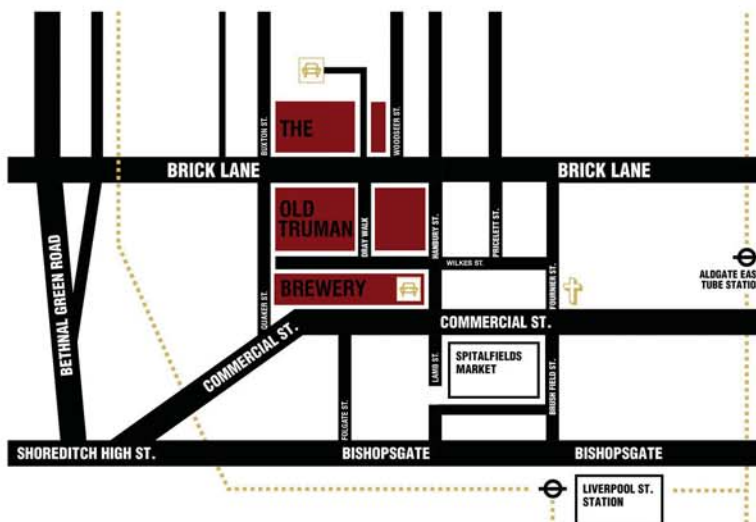

CONTACT

020 7770 6100

events@trumanbrewery.com

www.trumanbrewery.com

The Old Truman Brewery

91 Brick Lane London E1 6QL

MISREPRESENTATION ACT

The particulars of this brochure are believed to be correct, but accuracy cannot be guaranteed and they are expressly excluded from any contract.

THE
OLD TRUMAN
BREWERY